

MEMORIAL DESCRITIVO

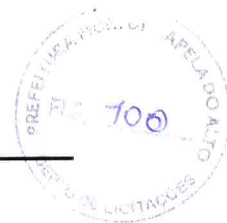

Descrição do Lote 06:

Terreno (Lote 06), Estrada Juvenal Moreira de Lara, lado par, Bairro do Itarassú, Município de Capela do Alto (SP).

Marco inicial: vértice 128-A (coordenadas N=7401907.463, E=218136.511).

Vértices, azimutes e distâncias, respectivos: 128-A/153-B, 57° 06' 28", 117,43m; 153-B/153-A, 156° 14' 21", 11,35m; 153-A/152, 156° 14' 21", 23,75; 152/151, R=50,00m, 5,55m; 151/151-A, 149° 53' 48", 24,25m; 151-A/150-A, 149° 53' 48", 35,96m; 150-A/126-A, 240° 16' 13", 114,69m; 126-A/127, 339° 20' 28", 21,42m; 127/128, 328° 22' 59", 14,81m; 128/128-A, 328° 23' 03", 58,26m.

Confrontantes: 128-A/153-B, Lote 05; 153-B/150-A, Rua Jorge Machado; 150-A/126-A, Lote 07; 126-A/128-A, Estrada Juvenal Moreira de Lara.

Área: 11.010,19 m²; perímetro de 427,47 m.

Capela do alto, 29 de março de 2023.



Lucas Godoy de Freitas Ferreira
Aut. do projeto e resp. téc. pelo levantamento
Engº Civil - CREA-SP 5070095851

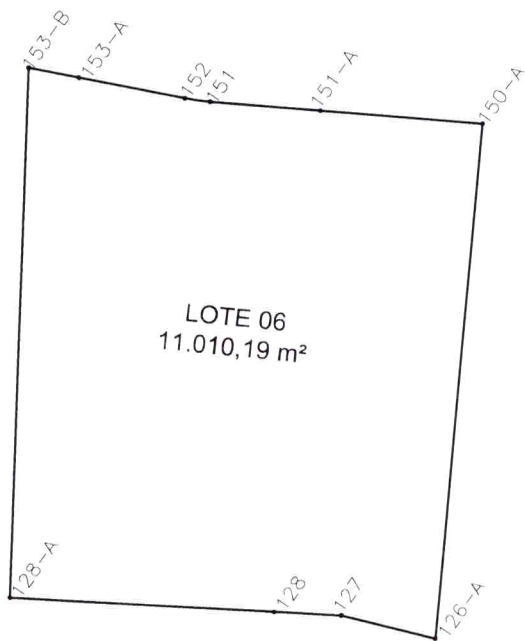
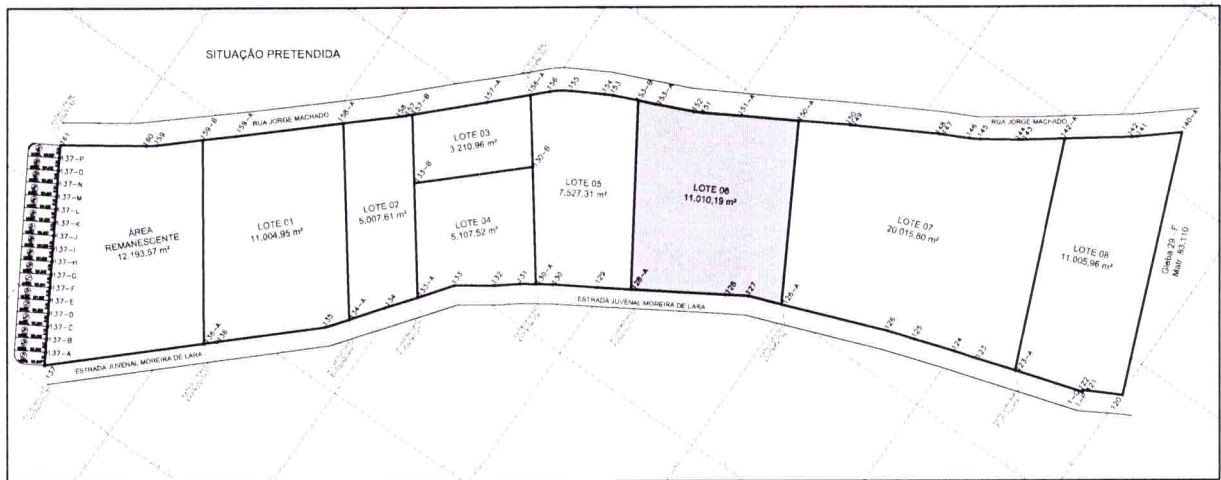
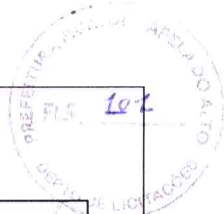

LOTE 06			
TABELA DE AZIMUTES E DISTÂNCIAS			
VERTICE	VERTICE	AZIMUTE	DISTANCIA (m)
128-A	153-B	57° 06' 28"	117,43
153-B	153-A	156° 14' 21"	11,35
153-A	152	156° 14' 21"	23,75
152	151	R=50,00	5,55
151	151-A	149° 53' 48"	24,25
151-A	150-A	149° 53' 48"	35,96
150-A	126-A	240° 16' 13"	114,69
126-A	127	339° 20' 28"	21,42
127	128	328° 22' 59"	14,81
128	128-A	328° 23' 03"	58,26
ÁREA: 11.010,19		PERÍMETRO: 427,47	

PREFEITURA MUNICIPAL DE CAPELA DO ALTO
OBRAS E SERVIÇOS



OBRA: **CONJUNTO INDUSTRIAL**
 LOCAL: **CONJUNTO INDUSTRIAL - BAIRRO CERCADINHO**
 LUCAS GODOY DE FREITAS FERREIRA
 CREASP 5070095851

DATA: **OUT/2021** ESCALA: **S/ ESCALA**